

APPROVED

FOR REFERENCE ONLY

REVISIONS				
ZONE	REV.	DESCRIPTION	DATE	APPROVED
	A	INITIAL RELEASE	5/30/2019	JP

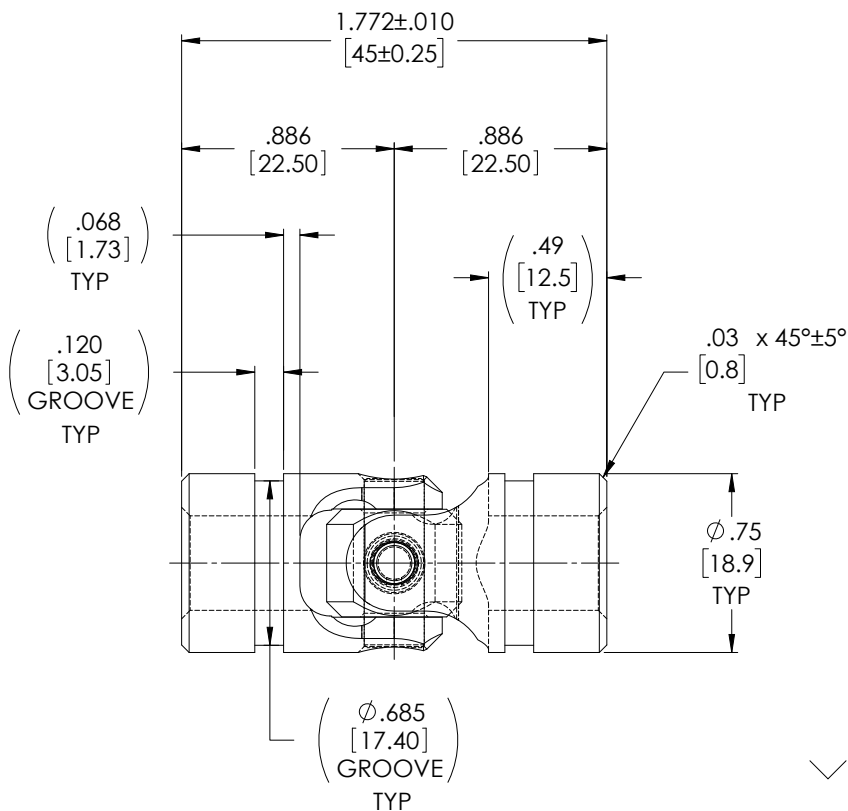
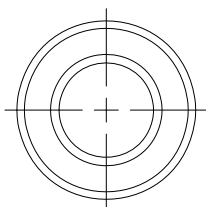
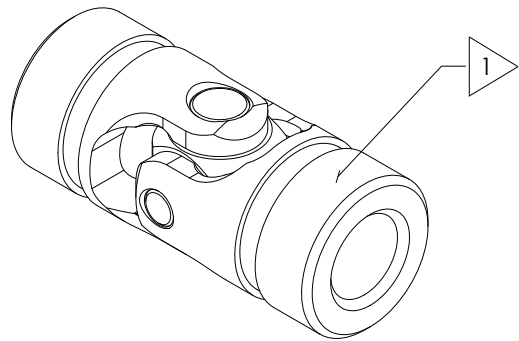

TYPICAL BOTH ENDS

NOTE(s), UNLESS OTHERWISE SPECIFIED.

1 MARK ASSEMBLY w/ "BELDEN" LOGO, PART NUMBER, REVISION LEVEL (IF ANY), DATE OF MANUFACTURE, & BELDEN JOB No.

(2) LUBRICATE U-JOINT w/ LUBRIPLATE # 1200-2, NLGI GRADE 2, AW/EP, LITHIUM GREASE OR EQUIVALENT.

(3) REF., MAXIMUM OPERATING ANGLE: 45°

DO NOT SCALE DRAWING

<small>UNLESS OTHERWISE SPECIFIED CHAMFER ALL HOLES BREAK ALL SHARP CORNERS DE-BURR ALL FEATURES</small>	<small>STANDARD TOLERANCES, UNLESS OTHERWISE SPECIFIED</small> <small>DIMENSIONS ARE IN INCHES [mm]</small> ANGULAR MACHINED: ±1.0° FRACTIONAL: ±.015" TWO PLACE DECIMAL: ±.010" THREE PLACE DECIMAL: ±.005" FOUR PLACE DECIMAL: ±.0005" CONCENTRICITY: .0025" T.I.R.	<small>MATERIAL</small> ALLOY STEEL <small>HEAT TREAT</small> SEE DETAIL DRAWINGS <small>FINISH</small> NONE	<small>INITIALS</small> JP	<small>DATE</small> 30MAY19	Belden Incorporated www.beldenuniversal.com ASSEMBLY, UNIVERSAL JOINT			
			<small>DRAWN</small> RNK	<small>DATE</small> 06/24/2019		<small>TITLE:</small>		
			<small>CHECKED</small> RNK	<small>DATE</small> 07/22/2019		<small>SIZE</small> A	<small>DWG. NO.</small> UJ-HD750x10	<small>REV</small> A
			<small>ENG APPR.</small> RNK	<small>MFG APPR.</small> []		<small>QC APPR.</small> []	<small>SCALE:</small> 2.5:1 WT (Lbs): 0.141	<small>SHEET 1 OF 2</small>