

REVISIONS				
ZONE	REV.	DESCRIPTION	DATE	APPROVED

INFORMATION IN THIS DRAWING
PROVIDED FOR REFERENCE ONLY

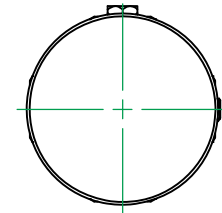
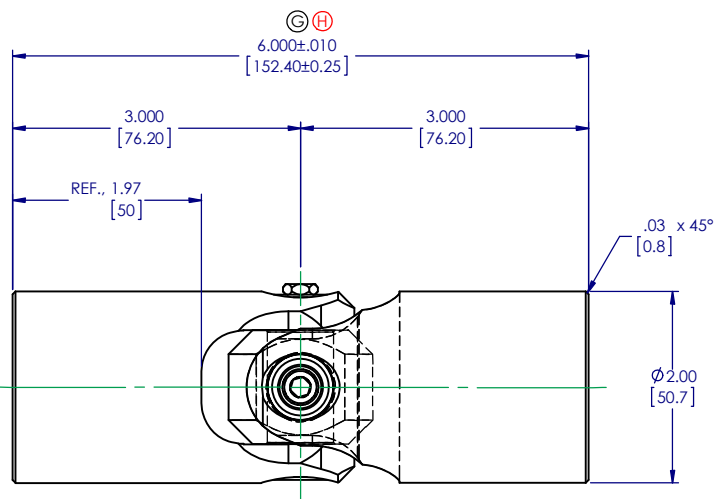
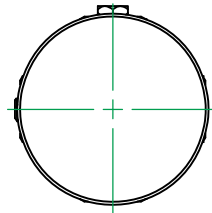
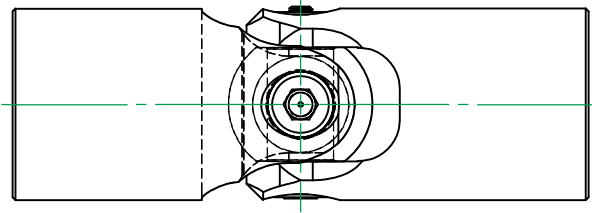
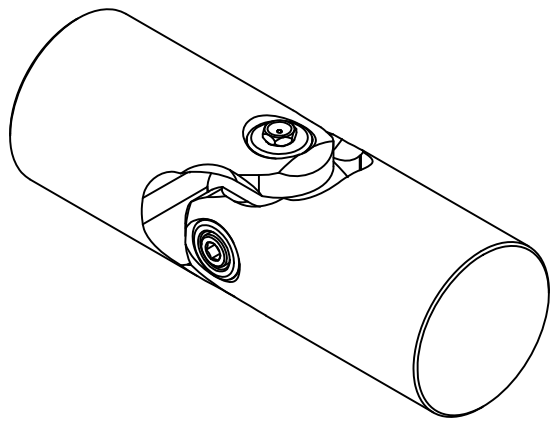

NOTE(S), UNLESS OTHERWISE SPECIFIED.

- Ⓔ (1) MARK ASSEMBLY w/ "BELDEN" LOGO, PART NUMBER, REVISION LEVEL (IF ANY), DATE OF MANUFACTURE & BELDEN JOB NUMBER.
- (2) LUBRICATE UNIVERSAL JOINT w/ LUBRIPLATE No. 3000, NLGI GRADE 2, AW/EP MOLY-LITHIUM GREASE.
- Ⓒ Ⓓ (3A) CLEAN THREADS OF SOCKET HEAD CAP SCREW AND LOCKNUT w/ LOC-TITE PRIMER #T7471.
- Ⓒ (3B) APPLY LOC-TITE #2760 THREADLOCKER TO THREADS OF SHCS & LOCKNUT. TAKE CARE TO KEEP THREADS FREE OF GREASE.
- (3C) FULLY SEAT $\varnothing 1/4$ -28 SOCKET HEAD CAP SCREW & TORQUE TO 20 FT-LBS.
- Ⓒ Ⓓ (4) REFERENCE, UNIVERSAL JOINT CAPABLE OF OPERATING AT ANY ANGLE UP TO AND INCLUDING 30° .
- Ⓒ (5) removed

DO NOT SCALE DRAWING

UNLESS OTHERWISE SPECIFIED
CHAMFER ALL HOLES
BREAK ALL SHARP CORNERS
DE-BURR ALL FEATURES

TURNED SURFACES: $\sqrt{125}$

MILLED SURFACES: $\sqrt{125}$

PROPRIETARY AND CONFIDENTIAL

THE INFORMATION CONTAINED IN THIS DRAWING IS THE SOLE PROPERTY OF BELDEN INC OR P OR RATED. ANY REPRODUCTION IN PART OR AS A WHOLE WITHOUT THE WRITTEN PERMISSION OF BELDEN INCORPORATED IS PROHIBITED.

STANDARD TOLERANCES, UNLESS OTHERWISE SPECIFIED

DIMENSIONS ARE IN INCHES [mm]

ANGULAR MACHINED: $\pm 1.0^\circ$

FRACTIONAL: ± 0.015

TWO PLACE DECIMAL: ± 0.010

THREE PLACE DECIMAL: ± 0.005

FOUR PLACE DECIMAL: ± 0.0005

CONCENTRICITY: 0.0025 TLR.

ALL HOLES TO BE LOCATED ON CENTERLINE (±) WITHIN .005" TLR.

INTERPRET GEOMETRIC TOLERANCES I.A.W. ANSI Y14.5M-1992

MATERIAL	ALLOY STEEL	NAME	RNK	DATE	19JUL99
DRAWN	RNK	NAME	RNK	DATE	19JUL99
CHECKED	RNK	NAME	RNK	DATE	19JUL99
ENG APPR.	RNK	NAME	RNK	DATE	19JUL99
MFG APPR.		NAME		DATE	
QA		NAME		DATE	
FINISH	SEE DETAIL(S)	COMMENTS			

Belden Incorporated
www.beldenuniversal.com

TITLE: ASSEMBLY, UNIVERSAL JOINT

SIZE DWG. NO. REV
C UJ-LV2000 J

SCALE: 1:1 WT (Lbs): 4.611 SHEET 1 OF 2